

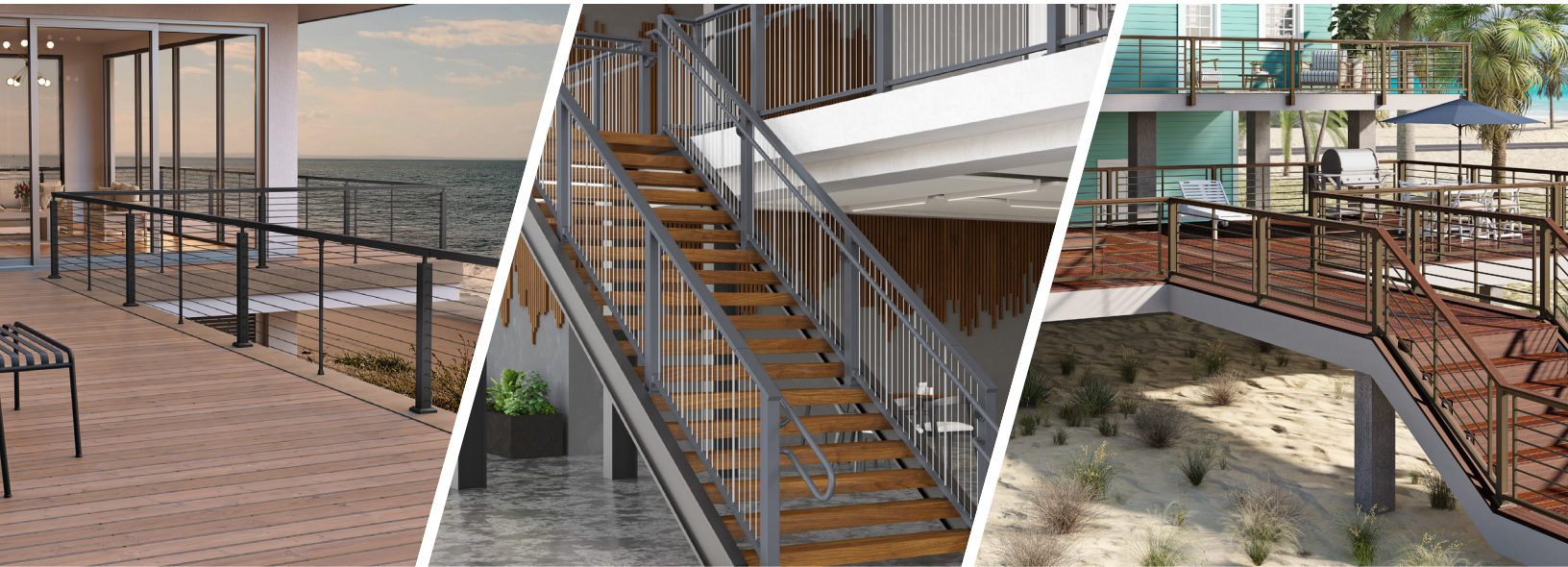

**KEYLINK**

# ALUMINUM RAILING COLORS & FINISHES



## STANDARD COLORS & FINISHES



TEXTURED BLACK

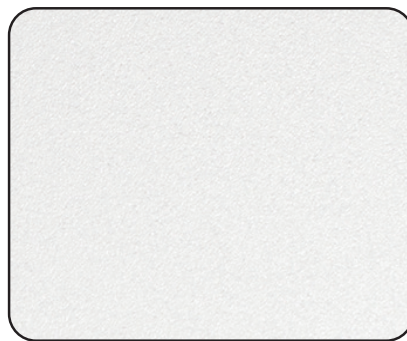

TEXTURED WHITE



TEXTURED BRONZE



MATTE BLACK



MATTE WHITE

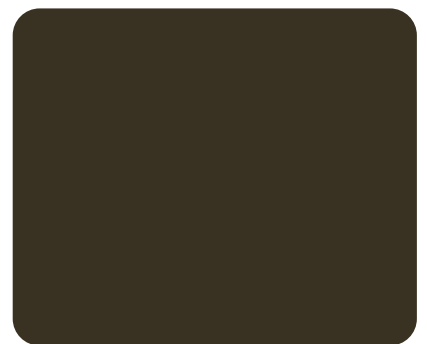

OIL RUBBED BRONZE

## SPECIAL ORDER COLORS & FINISHES



SATIN DRIFTWOOD



SATIN SMOKE



SATIN WILLOW



SATIN STORM



GLOSS BLACK



GLOSS WHITE



GLOSS BRONZE



GLOSS BEIGE



GLOSS SILVER



GLOSS KONA



GLOSS BROWNSTONE

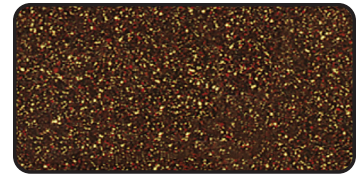

GLOSS SPECKLED WALNUT



GLOSS REDWOOD



GLOSS HUNTER GREEN



Scan the code to view our full collection of **colors and finishes** available for Special Order and Coastal Upgrade.

### MANUFACTURED IN THE USA

 Keylink's products are proudly designed and manufactured in the USA to ensure a quality fit and finish.

**NOTE** All Standard and Special Order Colors and Finishes are available with AAMA 2605 Coating with Coastal Upgrade except Matte White.

## POWDER COATING STANDARDS

### AAMA 2604 Standard Coating

Used on all Keylink products unless an upgrade is ordered. This level of protection balances effective coating with affordability, making it an excellent choice for outdoor aluminum.

### AAMA 2605 Coating with Coastal Upgrade

Strongly recommended for installations near bodies of water, especially saltwater. This upgrade includes a primer over all the aluminum before it's finished with AAMA 2605 standard coating. The coastal upgrade protects the aluminum from galvanic corrosion. Please note that a slight difference in colors is expected between AAMA 2604 and AAMA 2605 finishes. Please contact your Territory Manager for 2605 color swatches.



Keylink has received PCI-4000 Certification from the Powder Coating Institute, which is third-party confirmation that our process and coating meet the highest standards.